

Supersport Motorcycle Works
Front building
Ground Floor

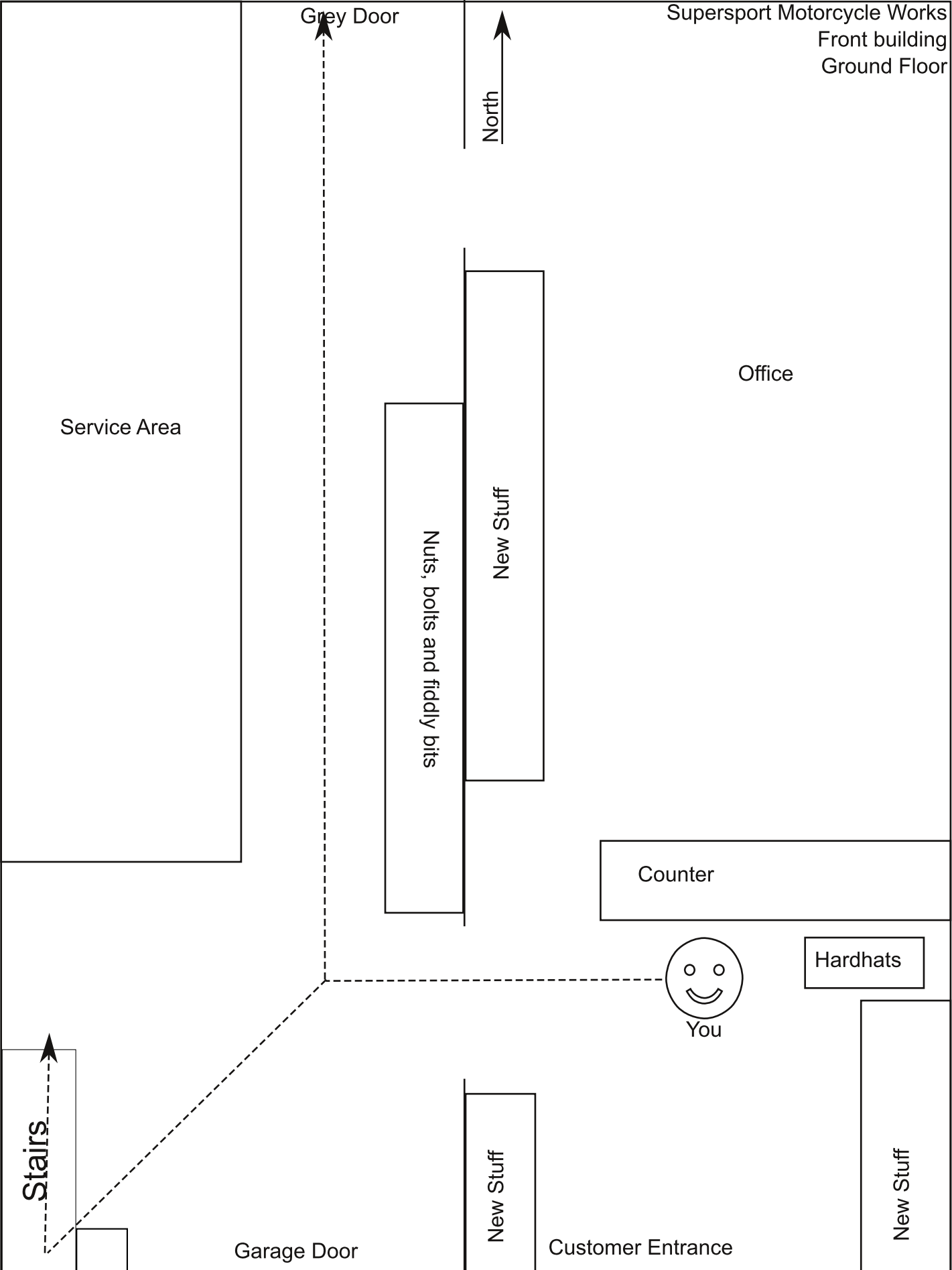

North

Grey Door

Office

Service Area

Nuts, bolts and fiddly bits

New Stuff

Counter

Hardhats

You

Stairs

New Stuff

New Stuff

Garage Door

Customer Entrance

Supersport Motorcycle Works
Front building
Upper Floor



H-Honda

sixth or second to last

G-Signals and Electrics

fifth

F-Carbs & Petcocks

fourth

E-Yamaha

third

D-Kawasaki

second

B-Suzuki

first

A*1 A*2

L*1
L*2 L*3

J*1
J*2
J*3
J*4

K*1 K*2

I*1

N*1

M*6
M*5
M*4
M*3
M*2
M*1

C-KLR and Sidecovers

Stairs

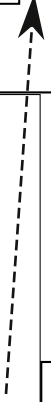

Map Key

First is general area

Second is shelf level, with 1 on the floor

Third is subsection within an area

Fuel tanks are hanging from ceiling and on upper shelves, not organized by Make

Up the stairs, take your first right, look to the right

A.1.1 Footpegs

Handlebar levers

Suspension springs

A.2.1 Rubber things

Spokes

A.3.1 Battery straps

Rubber things

Plastic clamps

Dipsticks and oil filler caps

Oil filter bolts

Chain rollers

Master cylinder caps

Drum brake cam arms

Brake unions

Anti-dive units

A.4.1 Brake pistons

A.1.2 Handlebar levers

Chain sliders and guides

Shift pedals

A.2.2 Fork caps and dust seals

Lever boots

A.3.2 Helmet locks

Gas caps

Throttles

Valve adjuster caps

Lightweight springs

Side and center stand springs

Carburetor clamps

Other clamps

Coiled clutch and brake cables to the left

Up the stairs, take your first right, look to your left

B.all Suzuki parts, binned by model

Up the stairs, go straight, look to your left

C.1.1 Plastic bodywork

C.2.1 KLR parts in bins

C.3.1 Sidecovers by Make

Up the stairs, go straight ahead, take your second right, on your left

D.all Kawasaki parts binned by model

Up the stairs, go straight ahead, take your third right, on your left

E.all Yamaha parts binned by model

Up the stairs, go straight ahead, take your fourth right, on your left

F.*.1 Carbs and throttle bodies

F.*.2 Carb parts- slides, needles, etc

F.*.3 Petcocks

Up the stairs, go straight ahead, take your fifth right, on your left, also sixth right (better lighting)

G.*.1 Turn signals by Make

G.*.2 Generators, wiring harnesses

G.*.3 Regulator/rectifiers

Up the stairs, go straight ahead, take your sixth right, on your left

H.all Honda parts binned by model

Up the stairs, take your first right, go all the way down, turn left, head all the way down

I.*.0 Gas caps on the floor

I.*.1 Fenders, mostly by Make and style

Up the stairs, take your first right, down a bit, next right, look to the right

J.1.1 Clip-on handlebars

Bar end weights

J.2.1 Round headlights, sealed and separate

J.3.1 Driving lights

Round headlight bezels

J.4.1 Sportbike windshields

J.1.2 Clip-on handlebars

Mirrors on stalks

J.2.2 Rectangular headlights

Modern headlight units

J.3.2 Round and rectangular headlight bezels

J.4.2 Sportbike windshields

J.1.3 Mirrors

J.2.3 Rectangular headlights

Mirrors on stalks

J.3.3 Throttle twistgrips

- Mounting brackets
- J.4.3 Sportbike windshields
- J.1.4 Fairing mount mirrors
- J.2.4 Fairing mount mirrors
- J.3.4 Loose throttle tubes
- Grips
- J.4.4 Misc plastics for fairings

Up the stairs, take your first right, then next right, all the way down, turn left, on your right

- K.1.1 Engine mounting brackets
- K.2.1 Engine mounting brackets
- Other brackets
- K.3.1 Long engine mounting bolts
- Exhaust flanges
- K.4.1 Exhaust flanges
- K.1.2 Axles
- K.2.2 Axles
- K.3.2 Axles
- K.4.2 Remains of a modern Triumph Triple

Up the stairs, take your first right, down a bit, past the next right, on your right

- L.1.1 Gauges
- L2.1 Handlebar mounts
- Mirror stalks
- Speedometer drives
- L.3.1 Speedometer drives and cables
- Rim locks
- L.4.1 Rim locks

Up the stairs, take your first right, then next right, on your left

- L.1.2 Gauges and instrument clusters
- L.2.2 Gauges and instrument clusters
- L.3.2 Headlight buckets
- Suzuki gauges
- L.4.2 Headlight buckets

Up the stairs, take your first right, all the way down, second right, on your right

- L.1.3 Yamaha gauges
- L.2.3 Steering dampers
- Frame sliders
- Brackets
- Honda dirt CDIs
- L.3.3 Mixed CDIs

Kawasaki street CDIs

Suzuki street CDIs

- L.4.3 Gauge lights and cluster covers

Up the stairs, take your first right, all the way down, second right, on your left

- M.1.1 Brake calipers
- M.2.1 Footpegs
- M.3.1 Cush drive bumpers
- Footpeg rubbers
- M.4.1 Yamaha tail lights
- M.1.2 Brake calipers
- M.2.2 Footpegs, some with pedals
- M.3.2 Footpegs, some clamp-on
- Cush drive bumpers
- M.4.2 Kawasaki tail lights
- M.1.3 Brake calipers
- M.2.3 Footpegs, some cruiser style
- M.3.3 Throttle cables
- M.4.3 Honda and Suzuki tail lights
- M.1.4 Brake calipers
- M.2.4 Footpegs
- M.3.4 Throttle cables
- M.4.4 Honda tail lights

Up the stairs, take your first right, all the way down, straight ahead

- M.1.5 Brake systems, front and rear
- M.2.5 Footpegs
- Suzuki dirt plastics
- M.3.5 Dirt side covers
- M.1.6 Master cylinders with levers
- M.2.6 Dirt footpegs
- Reflectors
- M.3.6 Dirt fenders

Up the stairs, take your first right, all the way down, go a little to the left

- N.1.1 Rear drum brake rods
- N.2.1 Handlebars
- N.3.1 Cruiser/handlebar mount windshields

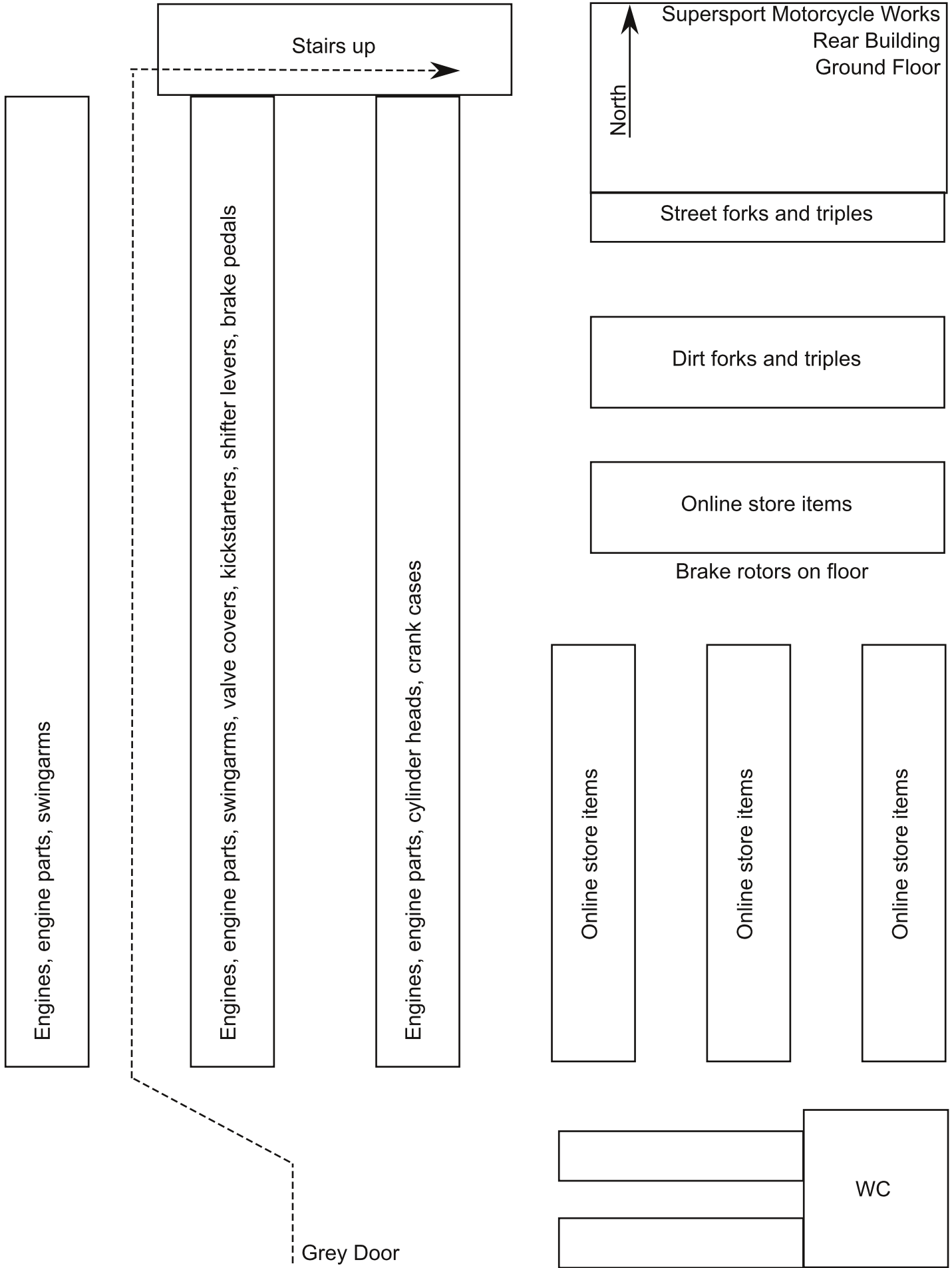

Engines, engine parts, swingarms

Stairs up

Engines, engine parts, swingarms, valve covers, kickstarters, shifter levers, brake pedals

Engines, engine parts, cylinder heads, crank cases

Supersport Motorcycle Works
Rear Building
Ground Floor

Street forks and triples

Dirt forks and triples

Online store items

Brake rotors on floor

Online store items

Online store items

Online store items

WC

Grey Door

North

